

## Adapter Sleeves for metric Shafts

$d_1$ mm	$d$ mm	$d_3$ mm	$B_1$ mm	$B_2$ mm	$B_3$ mm	Thread G mm	Mass kg	Designations	Lock nut	Locking Device	Hydraulic Nut
20	25	38	26	8	-	M25x1,5	0,064	H 205	KM 5	MB 5	-
	25	38	29	8	-	M25x1,5	0,071	H 305	KM 5	MB 5	-
	25	38	35	8	-	M25x1,5	0,085	H 2305	KM 5	MB 5	-
25	30	45	27	8	-	M30x1,5	0,086	H 206	KM 6	MB 6	-
	30	45	31	8	-	M30x1,5	0,095	H 306	KM 6	MB 6	-
	30	45	38	8	-	M30x1,5	0,11	H 2306	KM 6	MB 6	-
30	35	52	29	9	-	M35x1,5	0,12	H 207	KM 7	MB 7	-
	35	52	35	9	-	M35x1,5	0,14	H 307	KM 7	MB 7	-
	35	52	43	9	-	M35x1,5	0,16	H 2307	KM 7	MB 7	-
35	40	58	31	10	-	M40x1,5	0,16	H 208	KM 8	MB 8	-
	40	58	36	10	-	M40x1,5	0,17	H 308	KM 8	MB 8	-
	40	58	46	10	-	M40x1,5	0,22	H 2308	KM 8	MB 8	-
40	45	65	33	11	-	M45x1,5	0,21	H 209	KM 9	MB 9	-
	45	65	39	11	-	M45x1,5	0,23	H 309	KM 9	MB 9	-
	45	65	50	11	-	M45x1,5	0,27	H 2309	KM 9	MB 9	-
45	50	70	35	12	-	M50x1,5	0,24	H 210	KM 10	MB 10	HMV 10 E
	50	70	42	12	-	M50x1,5	0,27	H 310	KM 10	MB 10	HMV 10 E
	50	70	55	12	-	M50x1,5	0,34	H 2310	KM 10	MB 10	HMV 10 E
50	55	75	37	12,5	-	M55x2	0,28	H 211	KM 11	MB 11	HMV 11 E
	55	75	45	12,5	-	M55x2	0,34	H 311	KM 11	MB 11	HMV 11 E
	55	75	59	12,5	-	M55x2	0,39	H 2311	KM 11	MB 11	HMV 11 E
55	60	80	38	12,5	-	M60x2	0,31	H 212	KM 12	MB 12	HMV 12 E
	60	80	47	12,5	-	M60x2	0,36	H 312	KM 12	MB 12	HMV 12 E
	60	80	62	12,5	-	M60x2	0,45	H 2312	KM 12	MB 12	HMV 12 E
60	65	85	40	13,5	-	M65x2	0,36	H 213	KM 13	MB 13	HMV 13 E
	65	85	50	13,5	-	M65x2	0,42	H 313	KM 13	MB 13	HMV 13 E
	65	85	65	13,5	-	M65x2	0,52	H 2313	KM 13	MB 13	HMV 13 E
70	70	92	45	13,5	-	M70x2	0,59	H 214	KM 14	MB 14	HMV 14 E
	70	92	41	13,5	-	M70x2	0,67	H 314	KM 14	MB 14	HMV 14 E
	70	92	68	13,5	-	M70x2	0,88	H 2314	KM 14	MB 14	HMV 14 E
65	75	98	43	14,5	-	M75x2	0,66	H 215	KM 15	MB 15	HMV 15 E
	75	98	55	14,5	-	M75x2	0,78	H 315	KM 15	MB 15	HMV 15 E
	75	98	73	14,5	-	M75x2	1,1	H 2315	KM 15	MB 15	HMV 15 E
70	80	105	46	17	-	M80x2	0,81	H 216	KM 16	MB 16	HMV 16 E
	80	105	59	17	-	M80x2	0,95	H 316	KM 16	MB 16	HMV 16 E
	80	105	78	17	-	M80x2	1,2	H 2316	KM 16	MB 16	HMV 16 E
75	85	110	50	18	-	M85x2	0,94	H 217	KM 17	MB 17	HMV 17 E
	85	110	63	18	-	M85x2	1,1	H 317	KM 17	MB 17	HMV 17 E
	85	110	82	18	-	M85x2	1,35	H 2317	KM 17	MB 17	HMV 17 E
80	90	120	52	18	-	M90x2	1,1	H 218	KM 18	MB 18	HMV 18 E
	90	120	65	18	-	M90x2	1,3	H 318	KM 18	MB 18	HMV 18 E
	90	120	86	18	-	M90x2	1,6	H 2318	KM 18	MB 18	HMV 18 E
85	95	125	55	19	-	M95x2	1,25	H 219	KM 19	MB 19	HMV 19 E
	95	125	68	19	-	M95x2	1,4	H 319	KM 19	MB 19	HMV 19 E
	95	125	90	19	-	M95x2	1,8	H 2319	KM 19	MB 19	HMV 19 E
90	100	130	58	20	-	M100x2	1,4	H 220	KM 20	MB 20	HMV 20 E
	100	130	71	20	-	M100x2	1,6	H 320	KM 20	MB 20	HMV 20 E
	100	130	76	20	-	M100x2	1,8	H 3120	KM 20	MB 20	HMV 20 E
	100	130	97	20	-	M100x2	2	H 2320	KM 20	MB 20	HMV 20 E

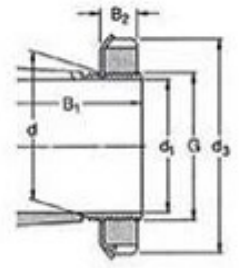
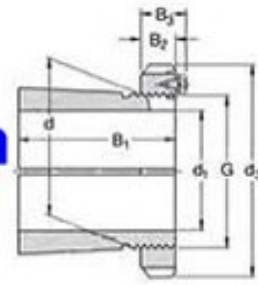

## Adapter Sleeves for metric Shafts

$d_1$ mm	$d$ mm	$d_3$ mm	$B_1$ mm	$B_2$ mm	$B_3$ mm	Thread G mm	Mass kg	Designations	Lock nut	Locking Device	Hydraulic Nut
100	110	145	63	21	-	M110x2	1,8	H 222	KM 22	MB 22	HMV 22 E
	110	145	77	21	-	M110x2	2,04	H 322	KM 22	MB 22	HMV 22 E
	110	145	81	21	-	M110x2	2,1	H 3122	KM 22	MB 22	HMV 22 E
	110	145	105	21	-	M110x2	2,75	H 2322	KM 22	MB 22	HMV 22 E
110	120	145	60	22	-	M120x2	1,7	H 3924	KML 24	MBL 24	HMV 24 E
	120	145	72	22	-	M120x2	1,8	H 3024	KML 24	MBL 24	HMV 24 E
	120	155	88	22	-	M120x2	2,5	H 3124	KM 24	MB 24	HMV 24 E
	120	155	112	22	-	M120x2	3	H 2324	KM 24	MB 24	HMV 24 E
115	130	155	65	23	-	M130x2	2,4	H 3926	KML 26	MBL 26	HMV 26 E
	130	155	80	23	-	M130x2	2,8	H 3026	KML 26	MBL 26	HMV 26 E
	130	165	92	23	-	M130x2	3,45	H 3126	KM 26	MB 26	HMV 26 E
	130	165	121	23	-	M130x2	4,45	H 2326	KM 26	MB 26	HMV 26 E
125	140	165	66	24	-	M140x2	2,7	H 3928	KML 28	MBL 28	HMV 28 E
	140	165	82	24	-	M140x2	3,05	H 3028	KML 28	MBL 28	HMV 28 E
	140	180	97	24	-	M140x2	4,1	H 3128	KM 28	MB 28	HMV 28 E
	140	180	131	24	-	M140x2	5,4	H 2328	KM 28	MB 28	HMV 28 E
135	150	180	76	26	-	M150x2	3,6	H 3930	KML 30	MBL 30	HMV 30 E
	150	180	87	26	-	M150x2	3,75	H 3030	KML 30	MBL 30	HMV 30 E
	150	195	111	26	-	M150x2	5,25	H 3130	KM 30	MB 30	HMV 30 E
	150	195	139	26	-	M150x2	6,4	H 2330	KM 30	MB 30	HMV 30 E
140	160	190	78	27,5	-	M160x3	4,6	H 3932	KML 32	MBL 32	HMV 32 E
	160	190	93	27,5	-	M160x3	5,1	H 3032	KML 32	MBL 32	HMV 32 E
	160	210	119	28	-	M160x3	7,25	H 3132	KM 32	MB 32	HMV 32 E
	160	210	147	28	-	M160x3	8,8	H 2332	KM 32	MB 32	HMV 32 E
150	170	200	79	28,5	-	M170x3	5	H 3934	KML 34	MBL 34	HMV 34 E
	170	200	101	28,5	-	M170x3	5,8	H 3034	KML 34	MBL 34	HMV 34 E
	170	220	122	29	-	M170x3	8,1	H 3134	KM 34	MB 34	HMV 34 E
	170	220	154	29	-	M170x3	9,9	H 2334	KM 34	MB 34	HMV 34 E
160	180	210	87	29,5	-	M180x3	5,7	H 3936	KML 36	MBL 36	HMV 36 E
	180	210	109	29,5	-	M180x3	6,7	H 3036	KML 36	MBL 36	HMV 36 E
	180	230	131	30	-	M180x3	9,15	H 3136	KM 36	MB 36	HMV 36 E
	180	230	161	30	-	M180x3	11	H 2336	KM 36	MB 36	HMV 36 E
170	190	220	89	30,5	-	M190x3	6,2	H 3938	KML 38	MBL 38	HMV 38 E
	190	220	112	30,5	-	M190x3	7,25	H 3038	KML 38	MBL 38	HMV 38 E
	190	240	141	31	-	M190x3	10,5	H 3138	KM 38	MB 38	HMV 38 E
	190	240	169	31	-	M190x3	12	H 2338	KM 38	MB 38	HMV 38 E
180	200	240	98	31,5	-	M200x3	7,9	H 3940	KML 40	MBL 40	HMV 40 E
	200	240	120	31,5	-	M200x3	8,9	H 3040	KML 40	MBL 40	HMV 40 E
	200	250	150	32	-	M200x3	12	H 3140	KM 40	MB 40	HMV 40 E
	200	250	176	32	-	M200x3	13,5	H 2340	KM 40	MB 40	HMV 40 E
200	220	260	96	30	41	Tr220x4	7,96	H 3944	HM 3044	MS 3044	HMV 44 E
	220	260	126	30	41	Tr220x4	9,9	H 3044	HM 3044	MS 3044	HMV 44 E
	220	280	161	35	-	Tr220x4	15	H 3144	HM 44 T	MB 44	HMV 44 E
	220	280	186	35	-	Tr220x4	17	H 2344	HM 44 T	MB 44	HMV 44 E
220	240	290	101	34	46	Tr240x4	11	H 3948	HM 3048	MS 3052-48	HMV 48 E
	240	290	133	34	46	Tr240x4	12	H 3048	HM 3048	MS 3052-48	HMV 48 E
	240	300	172	37	-	Tr240x4	16,5	H 3148	HM 48 T	MB 48	HMV 48 E
	240	300	199	37	-	Tr240x4	19	H 2348	HM 48 T	MB 48	HMV 48 E
240	260	310	116	34	46	Tr260x4	11,7	H 3952	HM 3052	MS 3052-48	HMV 52 E

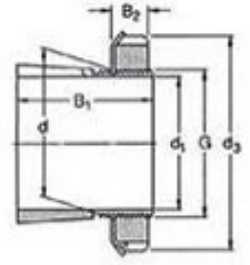
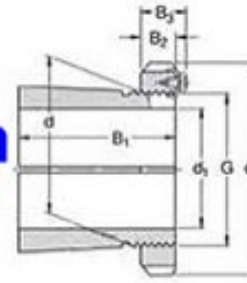

## Adapter Sleeves for metric Shafts

$d_1$ mm	$d$ mm	$d_3$ mm	$B_1$ mm	$B_2$ mm	$B_3$ mm	Thread G mm	Mass kg	Designations	Lock nut	Locking Device	Hydraulic Nut
	260	310	145	34	46	Tr260x4	13,5	H 3052	HM 3052	MS 3052-48	HMV 52 E
	260	330	190	39	-	Tr260x4	21	H 3152	HM 52 T	MB-52	HMV 52 E
	260	330	211	39	-	Tr260x4	23	H 2352	HM 52 T	MB-52	HMV 52 E
260	280	330	121	38	50	Tr280x4	15,3	H 3956	HM 3056	MS 3056	HMV 56 E
	280	330	152	38	50	Tr280x4	16	H 3056	HM 3056	MS 3056	HMV 56 E
	280	350	195	41	-	Tr280x4	23	H 3156	HM 56 T	MB 56	HMV 56 E
	280	350	224	41	-	Tr280x4	27	H 2356	HM 56 T	MB 56	HMV 56 E
280	300	360	140	42	54	Tr300x4	20	H 3960	HM 3060	MS 3060	HMV 60 E
	300	360	168	42	54	Tr300x4	20,5	H 3060	HM 3060	MS 3060	HMV 60 E
	300	380	208	40	53	Tr300x4	29	H 3160	HM 3160	MS 3160	HMV 60 E
	300	380	240	40	53	Tr300x4	32	H 3260	HM 3160	MS 3160	HMV 60 E
300	320	380	140	42	55	Tr320x5	21,5	H 3964	HM 3064	MS 3068-64	HMV 64 E
	320	380	171	42	55	Tr320x5	22	H 3064	HM 3064	MS 3068-64	HMV 64 E
	320	400	226	42	56	Tr320x5	32	H 3164	HM 3164	MS 3164	HMV 64 E
	320	400	258	42	56	Tr320x5	35	H 3264	HM 3164	MS 3164	HMV 64 E
320	340	400	144	45	58	Tr340x5	24,5	H 3968	HM 3068	MS 3068-64	HMV 68 E
	340	400	187	45	58	Tr340x5	27	H 3068	HM 3068	MS 3068-64	HMV 68 E
	340	440	254	55	72	Tr340x5	50	H 3168	HM 3168	MS 3172-68	HMV 68 E
	340	440	288	55	72	Tr340x5	51,5	H 3268	HM 3168	MS 3172-68	HMV 68 E
340	360	420	144	45	58	Tr360x5	25,2	H 3972	HM 3072	MS 3072	HMV 72 E
	360	420	188	45	58	Tr360x5	29	H 3072	HM 3072	MS 3072	HMV 72 E
	360	460	259	58	75	Tr360x5	56	H 3172	HM 3172	MS 3172-68	HMV 72 E
	360	460	299	58	75	Tr360x5	60,5	H 3272	HM 3172	MS 3172-68	HMV 72 E
360	380	450	164	48	62	Tr380x5	31,5	H 3976	HM 3076	MS 3080-76	HMV 76 E
	380	450	193	48	62	Tr380x5	35,5	H 3076	HM 3076	MS 3080-76	HMV 76 E
	380	490	264	60	77	Tr380x5	61,5	H 3176	HM 3176	MS 3176	HMV 76 E
	380	490	310	60	77	Tr380x5	69,5	H 3276	HM 3176	MS 3176	HMV 76 E
380	400	470	168	52	66	Tr400x5	35	H 3980	HM 3080	MS 3080-76	HMV 80 E
	400	470	210	52	66	Tr400x5	40	H 3080	HM 3080	MS 3080-76	HMV 80 E
	400	520	272	62	82	Tr400x5	73	H 3180	HM 3180	MS 3184-80	HMV 80 E
	400	520	328	62	82	Tr400x5	87	H 3280	HM 3180	MS 3184-80	HMV 80 E
400	420	490	168	52	66	Tr420x5	36	H 3984	HM 3084	MS 3084	HMV 84 E
	420	490	212	52	66	Tr420x5	47	H 3084	HM 3084	MS 3084	HMV 84 E
	420	540	304	70	90	Tr420x5	80	H 3184	HM 3184	MS 3184-80	HMV 84 E
	420	540	352	70	90	Tr420x5	96	H 3284	HM 3184	MS 3184-80	HMV 84 E
410	440	520	189	60	77	Tr440x5	58	H 3988	HM 3088	MS 3092-88	HMV 88 E
	440	520	228	60	77	Tr440x5	65	H 3088	HM 3088	MS 3092-88	HMV 88 E
	440	560	307	70	90	Tr440x5	95	H 3188	HM 3188	MS 3192-88	HMV 88 E
	440	560	361	70	90	Tr440x5	117	H 3288	HM 3188	MS 3192-88	HMV 88 E
430	460	540	189	60	77	Tr460x5	60	H 3992	HM 3092	MS 3092-88	HMV 92 E
	460	540	234	60	77	Tr460x5	71	H 3092	HM 3092	MS 3092-88	HMV 92 E
	460	580	326	75	95	Tr460x5	119	H 3192	HM 3192	MS 3192-88	HMV 92 E
	460	580	382	75	95	Tr460x5	134	H 3292	HM 3192	MS 3192-88	HMV 92 E
450	480	560	200	60	77	Tr480x5	66	H 3996	HM 3096	MS 30/500-96	HMV 96 E
	480	560	237	60	77	Tr480x5	75	H 3096	HM 3096	MS 30/500-96	HMV 96 E
	480	620	335	75	95	Tr480x5	135	H 3196	HM 3196	MS 3196	HMV 96 E
	480	620	397	75	95	Tr480x5	153	H 3296	HM 3196	MS 3196	HMV 96 E
470	500	580	247	68	85	Tr500x5	82	H 30/500	HM 30/500	MS 30/500-96	HMV 100 E
	500	580	208	68	85	Tr500x5	74,3	H 39/500	HM 30/500	MS 30/500-96	HMV 100 E

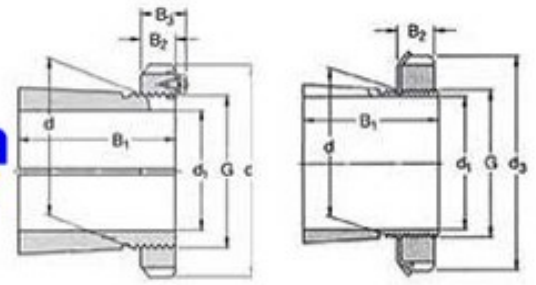

## Adapter Sleeves for metric Shafts

$d_1$ mm	$d$ mm	$d_3$ mm	$B_1$ mm	$B_2$ mm	$B_3$ mm	Thread G mm	Mass kg	Designations	Lock nut	Locking Device	Hydraulic Nut
	500	630	356	80	100	Tr500x5	145	H 31/500	HM 31/500	MS 31/500	HMV 100 E
	500	630	428	80	100	Tr500x5	170	H 32/500	HM 31/500	MS 31/500	HMV 100 E
500	530	630	216	68	90	Tr530x6	87,9	H 39/530	HM 30/530	MS 30/600-530	HMV 106 E
	530	630	265	68	90	Tr530x6	105	H 30/530	HM 30/530	MS 30/600-530	HMV 106 E
	530	670	364	80	105	Tr530x6	161	H 31/530	HM 31/530	MS 31/530	HMV 106 E
	530	670	447	80	105	Tr530x6	192	H 32/530	HM 31/530	MS 31/530	HMV 106 E
530	560	650	227	75	97	Tr560x6	95	H 39/560	HM 30/560	MS 30/560	HMV 112 E
	560	650	282	75	97	Tr560x6	112	H 30/560	HM 30/560	MS 30/560	HMV 112 E
	560	710	377	85	110	Tr560x6	185	H 31/560	HM 31/560	MS 31/600-560	HMV 112 E
	560	710	462	85	110	Tr560x6	219	H 32/560	HM 31/560	MS 31/600-560	HMV 112 E
560	600	700	239	75	97	Tr600x6	127	H 39/600	HM 30/600	MS 30/600-530	HMV 120 E
	600	700	289	75	97	Tr600x6	147	H 30/600	HM 30/600	MS 30/600-530	HMV 120 E
	600	750	399	85	110	Tr600x6	234	H 31/600	HM 31/600	MS 31/600-560	HMV 120 E
	600	750	487	85	110	Tr600x6	278	H 32/600	HM 31/600	MS 31/600-560	HMV 120 E
600	630	730	254	75	97	Tr630x6	124	H 39/630	HM 30/630	MS 30/630	HMV 126 E
	630	730	301	75	97	Tr630x6	138	H 30/630	HM 30/630	MS 30/630	HMV 126 E
	630	800	424	95	120	Tr630x6	254	H 31/630	HM 31/630	MS 31/630	HMV 126 E
630	670	780	264	80	102	Tr670x6	162	H 39/670	HM 30/670	MS 30/670	HMV 134 E
	670	780	324	80	102	Tr670x6	190	H 30/670	HM 30/670	MS 30/670	HMV 134 E
	670	850	456	106	131	Tr670x6	340	H 31/670	HM 31/670	MS 31/670	HMV 134 E
	670	850	558	106	131	Tr670x6	401	H 32/670	HM 31/670	MS 31/670	HMV 134 E
670	710	830	286	90	112	Tr710x7	183	H 39/710	HM 30/710	MS 30/710	HMV 142 E
	710	830	342	90	112	Tr710x7	228	H 30/710	HM 30/710	MS 30/710	HMV 142 E
	710	900	467	106	135	Tr710x7	392	H 31/710	HM 31/710	MS 31/710	HMV 142 E
	710	900	572	106	135	Tr710x7	459	H 32/710	HM 31/710	MS 31/710	HMV 142 E
710	750	870	291	90	112	Tr750x7	213	H 39/750	HM 30/750	MS 30/800-750	HMV 150 E
	750	870	356	90	112	Tr750x7	248	H 30/750	HM 30/750	MS 30/800-750	HMV 150 E
	750	950	493	112	141	Tr750x7	432	H 31/750	HM 31/750	MS 31/800-750	HMV 150 E
	750	950	603	112	141	Tr750x7	508	H 32/750	HM 31/750	MS 31/800-750	HMV 150 E
750	800	920	303	90	112	Tr800x7	263	H 39/800	HM 30/800	MS 30/800-750	HMV 160 E
	800	920	366	90	112	Tr800x7	305	H 30/800	HM 30/800	MS 30/800-750	HMV 160 E
	800	1000	505	112	141	Tr800x7	515	H 31/800	HM 31/800	MS 31/800-750	HMV 160 E
	800	1000	618	112	141	Tr800x7	611	H 32/800	HM 31/800	MS 31/800-750	HMV 160 E
800	850	980	308	90	115	Tr850x7	292	H 39/850	HM 30/850	MS 30/900-850	HMV 170 E
	850	980	380	90	115	Tr850x7	344	H 30/850	HM30/850	MS 30/900-850	HMV 170 E
	850	1060	536	118	147	Tr850x7	590	H 31/850	HM 31/850	MS 31/850	HMV 170 E
	850	1060	651	118	147	Tr850x7	696	H 32/850	HM 31/850	MS 31/850	HMV 170 E
850	900	1030	326	100	125	Tr900x7	335	H 39/900	HM 30/900	MS 30/900-850	HMV 180 E
	900	1030	400	100	125	Tr900x7	392	H 30/900	HM 30/900	MS 30/900-850	HMV 180 E
	900	1120	557	125	154	Tr900x7	674	H 31/900	HM 31/900	MS 31/900	HMV 180 E
	900	1120	660	125	154	Tr900x7	775	H 32/900	HM 31/900	MS 31/900	HMV 180 E

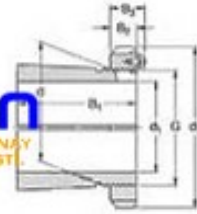

## Adapter Sleeves with Hydraulic

d <sub>1</sub>	d	d <sub>3</sub>	B <sub>1</sub>	B <sub>2</sub>	B <sub>3</sub>	G <sub>1</sub>	A	Thread G	Mass kg	Designations	Lock nut	Locking Device	Hydraulic Nut
mm	mm	mm	mm	mm	mm	mm	mm	mm	kg				
200	220	260	96	30	41	M6	4,2	Tr220x4	7,96	OH 3944 H	HM 3044	MS 3044	HMV 44 E
	220	260	126	30	41	M6	4,2	Tr220x4	9,9	OH 3044 H	HM 3044	MS 3044	HMV 44 E
	220	280	161	35	-	M6	4,2	Tr220x4	15	OH 3144 H	HM 44 T	MB 44	HMV 44 E
	220	280	186	35	-	M6	4,2	Tr220x4	17	OH 2344 H	HM 44 T	MB 44	HMV 44 E
220	240	290	101	34	46	M6	4,2	Tr240x4	11	OH 3948 H	HM 3048	MS 3052-48	HMV 48 E
	240	290	133	34	46	M6	4,2	Tr240x4	12	OH 3048 H	HM 3048	MS 3052-48	HMV 48 E
	240	300	172	37	-	M6	4,2	Tr240x4	15,1	OH 3148 H	HM 48 T	MB 48	HMV 48 E
	240	300	199	37	-	M6	4,2	Tr240x4	19	OH 2348 H	HM 48 T	MB 48	HMV 48 E
240	260	310	116	34	46	M6	4,2	Tr260x4	11,7	OH 3952 H	HM 3052	MS 3052-48	HMV 52 E
	260	310	145	34	46	M6	4,2	Tr260x4	13,5	OH 3052 H	HM 3052	MS 3052-48	HMV 52 E
	260	330	190	39	-	M6	4,2	Tr260x4	17,7	OH 3152 H	HM 52 T	MB-52	HMV 52 E
	260	330	211	39	-	M6	4,2	Tr260x4	23	OH 2352 H	HM 52 T	MB-52	HMV 52 E
260	280	330	121	38	50	M6	4,2	Tr280x4	15,3	OH 3956 H	HM 3056	MS 3056	HMV 56 E
	280	330	152	38	50	M6	4,2	Tr280x4	16	OH 3056 H	HM 3056	MS 3056	HMV 56 E
	280	350	195	41	-	M6	4,2	Tr280x4	23	OH 3156 H	HM 56 T	MB 56	HMV 56 E
	280	350	224	41	-	M6	4,2	Tr280x4	27	OH 2356 H	HM 56 T	MB 56	HMV 56 E
280	300	360	140	42	54	M6	4,2	Tr300x4	20	OH 3960 H	HM 3060	MS 3060	HMV 60 E
	300	360	168	42	54	M6	4,2	Tr300x4	20,5	OH 3060 H	HM 3060	MS 3060	HMV 60 E
	300	380	208	40	53	M6	4,2	Tr300x4	29	OH 3160 H	HM 3160	MS 3160	HMV 60 E
	300	380	240	40	53	M6	4,2	Tr300x4	32	OH 3260 H	HM 3160	MS 3160	HMV 60 E
300	320	380	140	42	55	M6	4	Tr320x5	21,5	OH 3964 H	HM 3064	MS 3068-64	HMV 64 E
	320	380	171	42	55	M6	4	Tr320x5	22	OH 3064 H	HM 3064	MS 3068-64	HMV 64 E
	320	400	226	42	56	M6	4	Tr320x5	32	OH 3164 H	HM 3164	MS 3164	HMV 64 E
	320	400	258	42	56	M6	4	Tr320x5	35	OH 3264 H	HM 3164	MS 3164	HMV 64 E
320	340	400	144	45	58	M6	4	Tr340x5	24,5	OH 3968 H	HM 3068	MS 3068-64	HMV 68 E
	340	400	187	45	58	M6	4	Tr340x5	27	OH 3068 H	HM 3068	MS 3068-64	HMV 68 E
	340	440	254	55	72	M6	4	Tr340x5	50	OH 3168 H	HM 3168	MS 3172-68	HMV 68 E
	340	440	288	55	72	M6	4	Tr340x5	51,5	OH 3268 H	HM 3168	MS 3172-68	HMV 68 E
340	360	420	144	45	58	M6	4	Tr360x5	25,2	OH 3972 H	HM 3072	MS 3072	HMV 72 E
	360	420	188	45	58	M6	4	Tr360x5	29	OH 3072 H	HM 3072	MS 3072	HMV 72 E
	360	460	259	58	75	M6	4	Tr360x5	56	OH 3172 H	HM 3172	MS 3172-68	HMV 72 E
	360	460	299	58	75	M6	4	Tr360x5	60,5	OH 3272 H	HM 3172	MS 3172-68	HMV 72 E
360	380	450	164	48	62	M6	4	Tr380x5	31,5	OH 3976 H	HM 3076	MS 3080-76	HMV 76 E
	380	450	193	48	62	M6	4	Tr380x5	35,5	OH 3076 H	HM 3076	MS 3080-76	HMV 76 E
	380	490	264	60	77	M6	4	Tr380x5	61,5	OH 3176 H	HM 3176	MS 3176	HMV 76 E
	380	490	310	60	77	M6	4	Tr380x5	69,5	OH 3276 H	HM 3176	MS 3176	HMV 76 E
380	400	470	168	52	66	M6	4	Tr400x5	35	OH 3980 H	HM 3080	MS 3080-76	HMV 80 E
	400	470	210	52	66	M6	4	Tr400x5	40	OH 3080 H	HM 3080	MS 3080-76	HMV 80 E
	400	520	272	62	82	M6	4	Tr400x5	73	OH 3180 H	HM 3180	MS 3184-80	HMV 80 E
	400	520	328	62	82	M6	4	Tr400x5	87	OH 3280 H	HM 3180	MS 3184-80	HMV 80 E
400	420	490	168	52	66	M6	4	Tr420x5	36	OH 3984 H	HM 3084	MS 3084	HMV 84 E
	420	490	212	52	66	M6	4	Tr420x5	47	OH 3084 H	HM 3084	MS 3084	HMV 84 E
	420	540	304	70	90	M6	4	Tr420x5	80	OH 3184 H	HM 3184	MS 3184-80	HMV 84 E
	420	540	352	70	90	M6	4	Tr420x5	96	OH 3284 H	HM 3184	MS 3184-80	HMV 84 E
410	440	520	189	60	77	M8	6,5	Tr440x5	58	OH 3988 H	HM 3088	MS 3092-88	HMV 88 E
	440	520	228	60	77	M8	6,5	Tr440x5	65	OH 3088 H	HM 3088	MS 3092-88	HMV 88 E
	440	560	307	70	90	M8	6,5	Tr440x5	95	OH 3188 H	HM 3188	MS 3192-88	HMV 88 E
	440	560	361	70	90	M8	6,5	Tr440x5	117	OH 3288 H	HM 3188	MS 3192-88	HMV 88 E
430	460	540	189	60	77	M8	6,5	Tr460x5	60	OH 3992 H	HM 3092	MS 3092-88	HMV 92 E

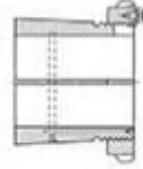
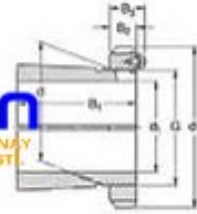

## Adapter Sleeves with Hydraulic

d <sub>1</sub>	d	d <sub>3</sub>	B <sub>1</sub>	B <sub>2</sub>	B <sub>3</sub>	G <sub>1</sub>	A	Thread G	Mass kg	Designations	Lock nut	Locking Device	Hydraulic Nut
mm	mm	mm	mm	mm	mm	mm	mm	mm	kg				
	460	540	234	60	77	M8	6,5	Tr460x5	71	OH 3092 H	HM 3092	MS 3092-88	HMV 92 E
	460	580	326	75	95	M8	6,5	Tr460x5	119	OH 3192 H	HM 3192	MS 3192-88	HMV 92 E
	460	580	382	75	95	M8	6,5	Tr460x5	134	OH 3292 H	HM 3192	MS 3192-88	HMV 92 E
450	480	560	200	60	77	M8	6,5	Tr480x5	66	OH 3996 H	HM 3096	MS 30/500-96	HMV 96 E
	480	560	237	60	77	M8	6,5	Tr480x5	75	OH 3096 H	HM 3096	MS 30/500-96	HMV 96 E
	480	620	335	75	95	M8	6,5	Tr480x5	135	OH 3196 H	HM 3196	MS 3196	HMV 96 E
	480	620	397	75	95	M8	6,5	Tr480x5	153	OH 3296 H	HM 3196	MS 3196	HMV 96 E
470	500	580	247	68	85	M8	6,5	Tr500x5	82	OH 30/500 H	HM 30/500	MS 30/500-96	HMV 100 E
	500	580	208	68	85	M8	6,5	Tr500x5	74,3	OH 39/500 H	HM 30/500	MS 30/500-96	HMV 100 E
	500	630	356	80	100	M8	6,5	Tr500x5	145	OH 31/500 H	HM 31/500	MS 31/500	HMV 100 E
	500	630	428	80	100	M8	6	Tr500x5	170	OH 32/500 H	HM 31/500	MS 31/500	HMV 100 E
500	530	630	216	68	90	M8	6	Tr530x6	87,9	OH 39/530 H	HM 30/530	MS 30/600-530	HMV 106 E
	530	630	265	68	90	M8	6	Tr530x6	105	OH 30/530 H	HM 30/530	MS 30/600-530	HMV 106 E
	530	670	364	80	105	M8	6	Tr530x6	161	OH 31/530 H	HM 31/530	MS 31/530	HMV 106 E
	530	670	447	80	105	M8	6	Tr530x6	192	OH 32/530 H	HM 31/530	MS 31/530	HMV 106 E
530	560	650	227	75	97	M8	6	Tr560x6	95	OH 39/560 H	HM 30/560	MS 30/560	HMV 112 E
	560	650	282	75	97	M8	6	Tr560x6	112	OH 30/560 H	HM 30/560	MS 30/560	HMV 112 E
	560	710	377	85	110	M8	6	Tr560x6	185	OH 31/560 H	HM 31/560	MS 31/600-560	HMV 112 E
	560	710	462	85	110	M8	6	Tr560x6	219	OH 32/560 H	HM 31/560	MS 31/600-560	HMV 112 E
560	600	700	239	75	97	1/8"	8	Tr600x6	127	OH 39/600 H	HM 30/600	MS 30/600-530	HMV 120 E
	600	700	289	75	97	1/8"	8	Tr600x6	147	OH 30/600 H	HM 30/600	MS 30/600-530	HMV 120 E
	600	750	399	85	110	1/8"	8	Tr600x6	234	OH 31/600 H	HM 31/600	MS 31/600-560	HMV 120 E
	600	750	487	85	110	1/8"	8	Tr600x6	278	OH 32/600 H	HM 31/600	MS 31/600-560	HMV 120 E
600	630	730	254	75	97	M8	6	Tr630x6	124	OH 39/630 H	HM 30/630	MS 30/630	HMV 126 E
	630	730	301	75	97	M8	6	Tr630x6	138	OH 30/630 H	HM 30/630	MS 30/630	HMV 126 E
	630	800	424	95	120	M8	6	Tr630x6	254	OH 31/630 H	HM 31/630	MS 31/630	HMV 126 E
630	670	780	264	80	102	1/8"	8	Tr670x6	162	OH 39/670 H	HM 30/670	MS 30/670	HMV 134 E
	670	780	324	80	102	1/8"	8	Tr670x6	190	OH 30/670 H	HM 30/670	MS 30/670	HMV 134 E
	670	850	456	106	131	1/8"	8	Tr670x6	340	OH 31/670 H	HM 31/670	MS 31/670	HMV 134 E
	670	850	558	106	131	1/8"	8	Tr670x6	401	OH 32/670 H	HM 31/670	MS 31/670	HMV 134 E
670	710	830	286	90	112	1/8"	8	Tr710x7	183	OH 39/710 H	HM 30/710	MS 30/710	HMV 142 E
	710	830	342	90	112	1/8"	8	Tr710x7	228	OH 30/710 H	HM 30/710	MS 30/710	HMV 142 E
	710	900	467	106	135	1/8"	8	Tr710x7	392	OH 31/710 H	HM 31/710	MS 31/710	HMV 142 E
	710	900	572	106	135	1/8"	8	Tr710x7	459	OH 32/710 H	HM 31/710	MS 31/710	HMV 142 E
710	750	870	291	90	112	1/8"	8	Tr750x7	213	OH 39/750 H	HM 30/750	MS 30/800-750	HMV 150 E
	750	870	356	90	112	1/8"	8	Tr750x7	248	OH 30/750 H	HM 30/750	MS 30/800-750	HMV 150 E
	750	950	493	112	141	1/8"	8	Tr750x7	432	OH 31/750 H	HM 31/750	MS 31/800-750	HMV 150 E
	750	950	603	112	141	1/8"	8	Tr750x7	508	OH 32/750 H	HM 31/750	MS 31/800-750	HMV 150 E
750	800	920	303	90	112	1/8"	10	Tr800x7	263	OH 39/800 H	HM 30/800	MS 30/800-750	HMV 160 E
	800	920	366	90	112	1/8"	10	Tr800x7	305	OH 30/800 H	HM 30/800	MS 30/800-750	HMV 160 E
	800	1000	505	112	141	1/8"	10	Tr800x7	515	OH 31/800 H	HM 31/800	MS 31/800-750	HMV 160 E
	800	1000	618	112	141	1/8"	10	Tr800x7	611	OH 32/800 H	HM 31/800	MS 31/800-750	HMV 160 E
800	850	980	308	90	115	1/8"	10	Tr850x7	292	OH 39/850 H	HM 30/850	MS 30/900-850	HMV 170 E
	850	980	380	90	115	1/8"	10	Tr850x7	344	OH 30/850 H	HM30/850	MS 30/900-850	HMV 170 E
	850	1060	536	118	147	1/8"	10	Tr850x7	590	OH 31/850 H	HM 31/850	MS 31/850	HMV 170 E
	850	1060	651	118	147	1/8"	10	Tr850x7	696	OH 32/850 H	HM 31/850	MS 31/850	HMV 170 E
850	900	1030	326	100	125	1/8"	10	Tr900x7	335	OH 39/900 H	HM 30/900	MS 30/900-850	HMV 180 E
	900	1030	400	100	125	1/8"	10	Tr900x7	392	OH 30/900 H	HM 30/900	MS 30/900-850	HMV 180 E
	900	1120	557	125	154	1/8"	10	Tr900x7	674	OH 31/900 H	HM 31/900	MS 31/900	HMV 180 E
	900	1120	660	125	154	1/8"	10	Tr900x7	775	OH 32/900 H	HM 31/900	MS 31/900	HMV 180 E

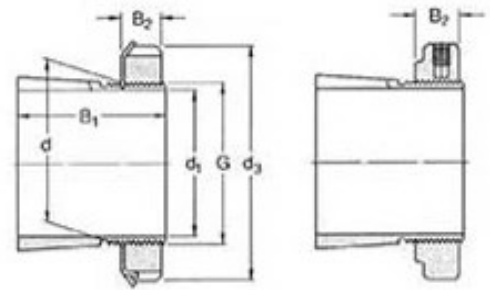

## Adapter Sleeves for inch Shafts

d <sub>1</sub> mm	d mm	d <sub>3</sub> mm	B <sub>1</sub> mm	Thread G mm	d <sub>1</sub> inch	Mass kg	Designations	Lock nut	Locking Device	Hydraulic Nut
19,050	25	38	26	M 25x1.5	3/8	0,07	HE 205	KM 5	MB 5	-
	25	38	29	M 25x1.5	3/8	0,08	HE 305	KM 5	MB 5	-
	25	38	35	M 25x1.5	3/8	0,09	HE 2305	KM 5	MB 5	-
22,225	30	45	27	M 30x1.5	7/8	0,11	HS 206	KM 6	MB 6	-
	30	45	31	M 30x1.5	7/8	0,12	HS 306	KM 6	MB 6	-
23,813	30	45	27	M 30x1.5	15/16	0,1	HA 206	KM 6	MB 6	-
	30	45	31	M 30x1.5	15/16	0,12	HA 306	KM 6	MB 6	-
	30	45	38	M 30x1.5	15/16	0,13	HA 2306	KM 6	MB 6	-
25,400	30	45	27	M 30x1.5	1	0,08	HE 206	KM 6	MB 6	-
	30	45	31	M 30x1.5	1	0,1	HE 306	KM 6	MB 6	-
	30	45	38	M 30x1.5	1	0,11	HE 2306	KM 6	MB 6	-
28,575	35	52	29	M 35x1.5	1 1/8	0,14	HS 207	KM 7	MB 7	-
	35	52	35	M 35x1.5	1 1/8	0,16	HS 307	KM 7	MB 7	-
30,163	35	52	29	M 35x1.5	1 3/16	0,12	HA 207	KM 7	MB 7	-
	35	52	35	M 35x1.5	1 3/16	0,14	HA 307	KM 7	MB 7	-
	35	52	43	M 35x1.5	1 3/16	0,16	HA 2307	KM 7	MB 7	-
31,750	40	58	31	M 40x1.5	1 1/4	0,19	HE 208	KM 8	MB 8	-
	40	58	36	M 40x1.5	1 1/4	0,22	HE 308	KM 8	MB 8	-
	40	58	46	M 40x1.5	1 1/4	0,28	HE 2308	KM 8	MB 8	-
34,925	40	58	31	M 40x1.5	1 3/8	0,16	HS 208	KM 8	MB 8	-
	40	58	36	M 40x1.5	1 3/8	0,17	HS 308	KM 8	MB 8	-
36,513	45	65	33	M 45x1.5	1 7/16	0,26	HA 209	KM 9	MB 9	-
	45	65	39	M 45x1.5	1 7/16	0,29	HA 309	KM 9	MB 9	-
	45	65	50	M 45x1.5	1 7/16	0,35	HA 2309	KM 9	MB 9	-
38,100	45	65	33	M 45x1.5	1 1/2	0,2	HE 209	KM 9	MB 9	-
	45	65	39	M 45x1.5	1 1/2	0,24	HE 309	KM 9	MB 9	-
	45	65	50	M 45x1.5	1 1/2	0,31	HE 2309	KM 9	MB 9	-
41,275	50	70	35	M 50x1.5	1 5/8	0,31	HS 210	KM 10	MB 10	HMV 10 E
	50	70	42	M 50x1.5	1 5/8	0,36	HS 310	KM 10	MB 10	HMV 10 E
	50	70	55	M 50x1.5	1 5/8	0,4	HS 2310	KM 10	MB 10	HMV 10 E
42,862	50	70	35	M 50x1.5	1 11/16	0,28	HA 210	KM 10	MB 10	HMV 10 E
	50	70	42	M 50x1.5	1 11/16	0,32	HA 310	KM 10	MB 10	HMV 10 E
	50	70	55	M 50x1.5	1 11/16	0,4	HA 2310	KM 10	MB 10	HMV 10 E
44,450	50	70	35	M 50x1.5	1 3/4	0,26	HE 210	KM 10	MB 10	HMV 10 E
	50	70	42	M 50x1.5	1 3/4	0,29	HE 310	KM 10	MB 10	HMV 10 E
	50	70	55	M 50x1.5	1 3/4	0,36	HE 2310	KM 10	MB 10	HMV 10 E
47,625	55	75	37	M 55x2	1 7/8	0,33	HS 211	KM 11	MB 11	HMV 11 E
	55	75	45	M 55x2	1 7/8	0,38	HS 311	KM 11	MB 11	HMV 11 E
49,212	55	75	37	M 55x2	1 15/16	0,3	HA 211	KM 11	MB 11	HMV 11 E
	55	75	45	M 55x2	1 15/16	0,34	HA 311	KM 11	MB 11	HMV 11 E
	55	75	59	M 55x2	1 15/16	0,42	HA 2311	KM 11	MB 11	HMV 11 E
53,975	60	80	38	M 60x2	2 1/8	0,35	HS 212	KM 12	MB 12	HMV 12 E
	60	80	47	M 60x2	2 1/8	0,4	HS 312	KM 12	MB 12	HMV 12 E
	60	80	62	M 60x2	2 1/8	0,49	HS 2312	KM 12	MB 12	HMV 12 E
55,563	65	85	40	M 65x2	2 3/16	0,49	HA 213	KM 13	MB 13	HMV 13 E
	65	85	50	M 65x2	2 3/16	0,58	HA 313	KM 13	MB 13	HMV 13 E
	65	85	65	M 65x2	2 3/16	0,75	HA 2313	KM 13	MB 13	HMV 13 E
57,150	65	85	40	M 65x2	2 1/4	0,44	HE 213	KM 13	MB 13	HMV 13 E
	65	85	50	M 65x2	2 1/4	0,52	HE 313	KM 13	MB 13	HMV 13 E
	65	85	65	M 65x2	2 1/4	0,65	HE 2313	KM 13	MB 13	HMV 13 E

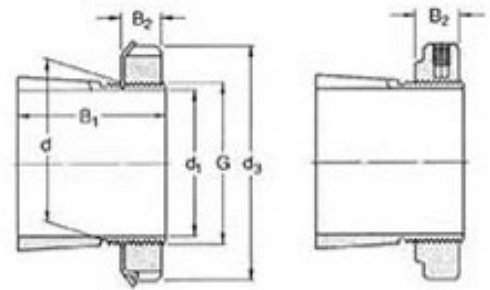

## Adapter Sleeves for inch Shafts

d <sub>1</sub> mm	d mm	d <sub>3</sub> mm	B <sub>1</sub> mm	Thread G mm	d <sub>1</sub> inch	Mass kg	Designations	Lock nut	Locking Device	Hydraulic Nut
60,325	65	85	40	M 65x2	2 3/8	0,44	HS 213	KM 13	MB 13	HMV 13 E
	65	85	50	M 65x2	2 3/8	0,71	HS 313	KM 13	MB 13	HMV 13 E
	65	85	65	M 65x2	2 3/8	0,8	HS 2313	KM 13	MB 13	HMV 13 E
61,913	75	98	43	M 75x2	2 7/16	0,75	HA 215	KM 15	MB 15	HMV 15 E
	75	98	55	M 75x2	2 7/16	0,91	HA 315	KM 15	MB 15	HMV 15 E
	75	98	73	M 75x2	2 7/16	1,15	HA 2315	KM 15	MB 15	HMV 15 E
63,500	75	98	43	M 75x2	2 1/2	0,7	HE 215	KM 15	MB 15	HMV 15 E
	75	98	55	M 75x2	2 1/2	0,85	HE 315	KM 15	MB 15	HMV 15 E
	75	98	73	M 75x2	2 1/2	1,09	HE 2315	KM 15	MB 15	HMV 15 E
66,675	75	98	43	M 75x2	2 5/8	0,7	HS 215	KM 15	MB 15	HMV 15 E
	75	98	55	M 75x2	2 5/8	0,71	HS 315	KM 15	MB 15	HMV 15 E
	75	98	73	M 75x2	2 5/8	0,9	HS 2315	KM 15	MB 15	HMV 15 E
68,263	80	105	46	M 80x2	2 11/16	0,87	HA 216	KM 16	MB 16	HMV 16 E
	80	105	59	M 80x2	2 11/16	1,05	HA 316	KM 16	MB 16	HMV 16 E
	80	105	78	M 80x2	2 11/16	1,3	HA 2316	KM 16	MB 16	HMV 16 E
69,850	80	105	46	M 80x2	2 3/4	0,81	HE 216	KM 16	MB 16	HMV 16 E
	80	105	59	M 80x2	2 3/4	0,97	HE 316	KM 16	MB 16	HMV 16 E
	80	105	78	M 80x2	2 3/4	1,2	HE 2316	KM 16	MB 16	HMV 16 E
74,612	85	110	50	M 85x2	2 15/16	0,94	HA 217	KM 17	MB 17	HMV 17 E
	85	110	63	M 85x2	2 15/16	1,1	HA 317	KM 17	MB 17	HMV 17 E
	85	110	82	M 85x2	2 15/16	1,4	HA 2317	KM 17	MB 17	HMV 17 E
76,200	85	110	50	M 85x2	3	0,87	HE 217	KM 17	MB 17	HMV 17 E
	85	110	63	M 85x2	3	1	HE 317	KM 17	MB 17	HMV 17 E
	85	110	82	M 85x2	3	1,3	HE 2317	KM 17	MB 17	HMV 17 E
80,963	90	120	52	M 90x2	3 3/16	1,05	HA 218	KM 18	MB 18	HMV 18 E
	90	120	65	M 90x2	3 3/16	1,25	HA 318	KM 18	MB 18	HMV 18 E
	90	120	86	M 90x2	3 3/16	1,5	HA 2318	KM 18	MB 18	HMV 18 E
82,550	90	120	52	M 90x2	3 1/4	0,97	HE 218	KM 18	MB 18	HMV 18 E
	90	120	65	M 90x2	3 1/4	1,1	HE 318	KM 18	MB 18	HMV 18 E
	90	120	86	M 90x2	3 1/4	1,4	HE 2318	KM 18	MB 18	HMV 18 E
87,313	95	125	55	M 95x2	3 1/4	1,35	HE 219	KM 19	MB 19	HMV 19 E
	95	125	68	M 95x2	3 1/4	1,6	HE 319	KM 19	MB 19	HMV 19 E
	95	125	90	M 95x2	3 1/4	2	HE 2319	KM 19	MB 19	HMV 19 E
88,900	100	130	58	M 100x2	3 7/16	1,55	HA 220	KM 20	MB 20	HMV 20 E
	100	130	71	M 100x2	3 7/16	1,8	HA 320	KM 20	MB 20	HMV 20 E
	100	130	97	M 100x2	3 7/16	2,35	HA 2320	KM 20	MB 20	HMV 20 E
101,600	100	130	58	M 100x2	3 1/2	1,45	HE 220	KM 20	MB 20	HMV 20 E
	100	130	71	M 100x2	3 1/2	1,75	HE 320	KM 20	MB 20	HMV 20 E
	100	130	76	M 100x2	3 1/2	1,8	HE 3120	KM 20	MB 20	HMV 20 E
106,362	100	130	97	M 100x2	3 1/2	2,2	HE 2320	KM 20	MB 20	HMV 20 E
	110	145	63	M 110x2	4	1,65	HE 222	KM 22	MB 22	HMV 22 E
	110	145	77	M 110x2	4	1,9	HE 322	KM 22	MB 22	HMV 22 E
107,950	110	145	81	M 110x2	4	2,25	HE 3122	KM 22	MB 22	HMV 22 E
	110	145	105	M 110x2	4	2,4	HE 2322	KM 22	MB 22	HMV 22 E
	120	145	72	M 120x2	4 3/16	2,25	HA 3024	KML 24	MBL 24	HMV 24 E
106,362	120	155	88	M 120x2	4 3/16	2,9	HA 3124	KM 24	MB 24	HMV 24 E
	120	155	112	M 120x2	4 3/16	3,6	HA 2324	KM 24	MB 24	HMV 24 E
	120	145	72	M 120x2	4 1/4	2	HE 3024	KML 24	MBL 24	HMV 24 E
107,950	120	155	88	M 120x2	4 1/4	2,8	HE 3124	KM 24	MB 24	HMV 24 E
	120	155	112	M 120x2	4 1/4	3,35	HE 2324	KM 24	MB 24	HMV 24 E



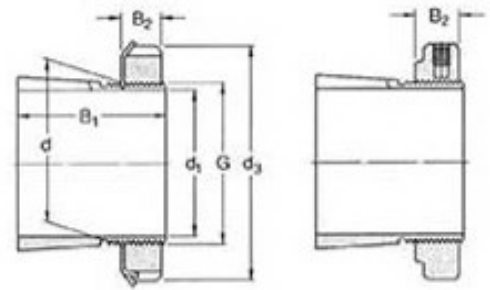

## Adapter Sleeves for inch Shafts

d <sub>1</sub> mm	d mm	d <sub>3</sub> mm	B <sub>1</sub> mm	Thread G mm	d <sub>1</sub> inch	Mass kg	Designations	Lock nut	Locking Device	Hydraulic Nut
112,713	130	155	80	M 130x2	4 7/16	3,05	HA 3026	KML 26	MBL 26	HMV 26 E
	130	165	92	M 130x2	4 7/16	3,75	HA 3126	KM 26	MB 26	HMV 26 E
	130	165	121	M 130x2	4 7/16	4,74	HA 2326	KM 26	MB 26	HMV 26 E
114,300	130	155	80	M 130x2	4 1/2	2,9	HE 3026	KML 26	MBL 26	HMV 26 E
	130	165	92	M 130x2	4 1/2	3,6	HE 3126	KM 26	MB 26	HMV 26 E
	130	165	121	M 130x2	4 1/2	4,55	HE 2326	KM 26	MB 26	HMV 26 E
125,412	140	165	82	M 140x2	4 15/16	3	HA 3028	KML 28	MBL 28	HMV 28 E
	140	180	97	M 140x2	4 15/16	4,1	HA 3128	KM 28	MB 28	HMV 28 E
	140	180	131	M 140x2	4 15/16	5,3	HA 2328	KM 28	MB 28	HMV 28 E
127,000	140	165	82	M 140x2	5	2,8	HE 3028	KML 28	MBL 28	HMV 28 E
	140	180	97	M 140x2	5	3,8	HE 3128	KM 28	MB 28	HMV 28 E
	140	180	131	M 140x2	5	5	HE 2328	KM 28	MB 28	HMV 28 E
131,762	150	180	87	M 150x2	5 3/16	4,2	HA 3030	KML 30	MBL 30	HMV 30 E
	150	195	111	M 150x2	5 3/16	5,8	HA 3130	KM 30	MB 30	HMV 30 E
	150	195	139	M 150x2	5 3/16	7,1	HA 2330	KM 30	MB 30	HMV 30 E
133,350	150	180	87	M 150x2	5 1/4	4	HE 3030	KML 30	MBL 30	HMV 30 E
	150	195	111	M 150x2	5 1/4	5,5	HE 3130	KM 30	MB 30	HMV 30 E
	150	195	139	M 150x2	5 1/4	6,8	HE 2330	KM 30	MB 30	HMV 30 E
138,113	160	190	93	M 160x3	5 7/16	5,4	HA 3032	KML 32	MBL 32	HMV 32 E
	160	210	119	M 160x3	5 7/16	7,55	HA 3132	KM 32	MB 32	HMV 32 E
	160	210	147	M 160x3	5 7/16	9,4	HA 2332	KM 32	MB 32	HMV 32 E
139,700	160	190	93	M 160x3	5 1/2	5,1	HE 3032	KML 32	MBL 32	HMV 32 E
	160	210	119	M 160x3	5 1/2	7,3	HE 3132	KM 32	MB 32	HMV 32 E
	160	210	147	M 160x3	5 1/2	8,8	HE 2332	KM 32	MB 32	HMV 32 E
150,813	170	200	101	M 170x3	5 15/16	5,7	HA 3034	KML 34	MBL 34	HMV 34 E
	170	220	122	M 170x3	5 15/16	7,8	HA 3134	KM 34	MB 34	HMV 34 E
	170	220	154	M 170x3	5 15/16	9,6	HA 2334	KM 34	MB 34	HMV 34 E
152,400	170	200	101	M 170x3	6	5,4	HE 3034	KML 34	MBL 34	HMV 34 E
	170	220	122	M 170x3	6	7,55	HE 3134	KM 34	MB 34	HMV 34 E
	170	220	154	M 170x3	6	9,2	HE 2334	KM 34	MB 34	HMV 34 E
163,512	180	210	109	M 180x3	6 7/16	6	HA 3036	KML 36	MBL 36	HMV 36 E
	180	230	131	M 180x3	6 7/16	8,15	HA 3136	KM 36	MB 36	HMV 36 E
	180	230	161	M 180x3	6 7/16	9,9	HA 2336	KM 36	MB 36	HMV 36 E
165,100	180	210	109	M 180x3	6 1/2	5,55	HE 3036	KML 36	MBL 36	HMV 36 E
	180	230	131	M 180x3	6 1/2	7,8	HE 3136	KM 36	MB 36	HMV 36 E
	180	230	161	M 180x3	6 1/2	9,35	HE 2336	KM 36	MB 36	HMV 36 E
171,450	190	220	112	M 190x3	6 3/4	7,2	HE 3038	KML 38	MBL 38	HMV 38 E
	190	240	141	M 190x3	6 3/4	10,2	HE 3138	KM 38	MB 38	HMV 38 E
	190	240	169	M 190x3	6 3/4	11,7	HE 2338	KM 38	MB 38	HMV 38 E
176,213	190	220	112	M 190x3	6 15/16	5,8	HA 3038	KML 38	MBL 38	HMV 38 E
	190	240	141	M 190x3	6 15/16	8,5	HA 3138	KM 38	MB 38	HMV 38 E
	190	240	169	M 190x3	6 15/16	10	HA 2338	KM 38	MB 38	HMV 38 E
177,800	200	240	120	M 200x3	7	9,35	HE 3040	KML 40	MBL 40	HMV 40 E
	200	250	150	M 200x3	7	12,3	HE 3140	KM 40	MB 40	HMV 40 E
	200	250	176	M 200x3	7	14,2	HE 2340	KM 40	MB 40	HMV 40 E
182,563	200	240	120	M 200x3	7 3/16	8,25	HA 3040	KML 40	MBL 40	HMV 40 E
	200	250	150	M 200x3	7 3/16	11,2	HA 3140	KM 40	MB 40	HMV 40 E
	200	250	176	M 200x3	7 3/16	12,6	HA 2340	KM 40	MB 40	HMV 40 E